

Laguna



Beautifully simple
water gardening



CONTENTS:

Top Tips	1
PowerJet Fountain & Waterfall Pump Kit	2
MaxFlo Waterfall & Pump Kit	4
Underwater Filters	6
External Filters	8
Skimmer Filter Pumps	8
Filter Material	10
UV Sterilizers/Clarifiers	12
Spitters	14
PowerGlo Underwater Pond Kit	18
Water Test Kits, Strips & Treatments	19
Water Treatments	20
Goldfish & Koi Fish Food	22
Pond Nets & Skimmers	24
Floating Thermometer	25
Live Plant Accessories	26
Decorations	28
Winterizing a Pond	29
Water Feature Kits	30
Durasheid Pre-Formed Ponds	31
Whiskey Barrel Liner	32
Durasheid Pond Liners	32
Tubing	33
Your Questions Answered	34
How To Build A Pond	36
Parts & Accessories	Back Cover

TOP TIPS:

- 1.** Always treat pond water before adding live stock. Chlorine and chloramine in tap water may kill or injure fish. Use Laguna Water Prep for fast and effective dechlorination.
- 2.** Keep sharp objects away from pond liners.
- 3.** Install the pump on bricks or blocks to minimize clogging.
- 4.** The maximum height of your fountain should not exceed half the width of your pond.
- 5.** Allow for 1 inch of fish per square foot of surface area. You can allow 2 inches per square foot with improved filtration from a fountain or waterfall.
- 6.** If you are going to keep large Koi, they should be housed in large, well filtered ponds. The pond should be at least 3 ft (1 m) deep and have vertical sides projecting above the surface to prevent Koi from jumping out.
- 7.** Oxygenating plants provide oxygen only during daylight. Fish can suffer stress during warm, still nights unless extra oxygen is supplied. Water agitation created by a splashing fountain or waterfall is ideal.
- 8.** Although most pumps operate using a normal electrical supply, the installation should be a permanent one using a GFI (Ground Fault Interrupter). Always use cables and connectors designed for outdoor and water garden use. Have your system installed or checked by an electrician.
- 9.** *THE FINISHING TOUCHES*
It's important to choose the right fish and plants for your pond. Consult your local pet shop and garden center for advice.

POWERJET NEW CAGE DESIGN!

EVERYTHING BEGINS WITH A POWERJET PUMP

PowerJet Pumps can be easily submerged at the bottom of the pond to provide waterflow to power waterfalls, fountains, ornaments, filter systems and PowerClear units easily and reliably with low power consumption. Every PowerJet Pump comes complete with a riser stem and two fountain heads. Fountainheads are also available separately.

"3-Tier" and "Waterbell" Fountain heads included. Optional "Foam Jet" Fountain head available

Universal 'Click'-fit inlet connection for Underwater PowerFlo filters

Ergonomic pump handle for easy transportation

Large surface capacity for maximum mechanical filtration

Telescopic Removable Riser Stem

Lowest operating cost from 6.5W to 130W

Two flow control valves for fountain head and diverter connection

Pump cage can be anchored to a fitted ballast, allowing easy removal for service with a twisting motion

Easy connection with 'Click'-fit fittings

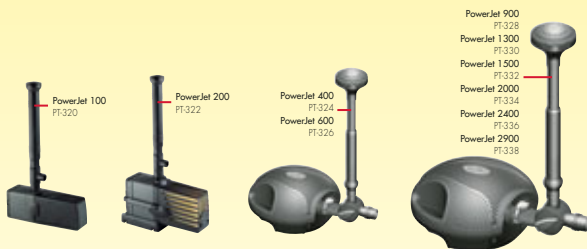

PowerJet Pumps are made to run quietly and reliably, with maximum power and performance and low operating costs! Even the largest pump uses only 130 watts.



POND WITH WATERFALL AND FOUNTAIN

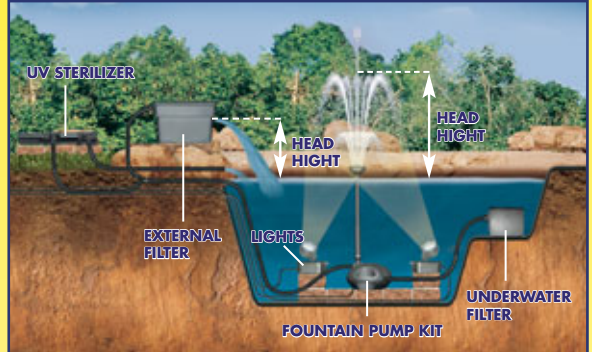

CALCULATE THE NUMBER OF GALLONS IN POND
DETERMINE FLOW RATE (GPH) REQUIRED

HOW TO PICK THE RIGHT LAGUNA PUMP

POND WITH FOUNTAIN: CHOOSE DESIRED HEAD HEIGHT OF FOUNTAIN (Distance between top of fountain and surface of pond). Then determine flow rate available from performance chart.

POND WITH WATERFALL: CHOOSE WATERFALL HEAD HEIGHT (Distance between top of waterfall and surface of pond). Add one foot of head height for every ten feet of connection hose required. Then determine flow rate available from performance chart. NOTE: Waterfall requires 75-100 gallons/hour flow rate for every inch of width.

POND WITH WATERFALL AND FOUNTAIN: COMBINE HEAD HEIGHT FOR FOUNTAIN PLUS WATERFALL. Add one foot of head height for every ten feet of connecting hose, then determine flow rate available from performance chart.

SPITTER FEATURE: Add one foot of head height for every ten feet of hose.

A LARGER PUMP PROVIDES THE FLEXIBILITY TO ADD MORE FEATURES LATER.

POWERJET PERFORMANCES

HEAD HEIGHT FLOW RATE/GPH (U.S.)	4'-3" MAXIMUM HEAD HEIGHT		5'-2" MAXIMUM HEAD HEIGHT		5'-10" MAXIMUM HEAD HEIGHT		6'-4" MAXIMUM HEAD HEIGHT		8'-6" MAXIMUM HEAD HEIGHT		13'-2" MAXIMUM HEAD HEIGHT		14'-5" MAXIMUM HEAD HEIGHT	
	3'	2'	3'	2'	3'	2'	4'	3'	6'	4'	10'	8'	12'	10'
	82	132	222	280	351	433	565	686	888	951	1162	1373	1664	1981
	3'	2'	3'	2'	3'	2'	3'	2'	4'	3'	6'	4'	8'	6'
GPH (U.S.)	200	400	600	900	1300	1500	2000	2400	2900					
FOUNTAIN PUMP KIT	PT.322	PT.324	PT.326	PT.328	PT.330	PT.332	PT.334	PT.336	PT.338					
POWERJET	200	400	600	900	1300	1500	2000	2400	2900	ELECTRONIC	ELECTRONIC	ELECTRONIC	ELECTRONIC	ELECTRONIC

MAX-FLO NEW CAGE DESIGN!

WATERFALL & FILTER PUMP HIGH PERFORMANCE, SOLIDS HANDLING STRAINER CAGE PROTECTS IMPELLER

Laguna Max-Flo Pumps employ an integrated electronic circuit board to continuously control impeller speed and force. This technological advancement produces the most powerful, energy efficient pumps on the market today. Compare watt to watt, gallon to gallon, Max-Flo Pumps outperform.

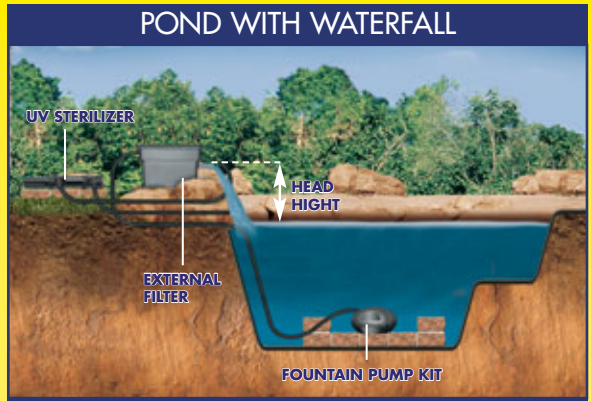
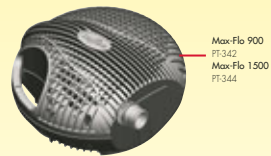

CALCULATE THE NUMBER OF GALLONS IN POND
DETERMINE FLOW RATE (GPH) REQUIRED

MAX-FLO PERFORMANCES

MAXIMUM HEAD HEIGHT	13'-5" MAXIMUM HEAD HEIGHT				14'-9" MAXIMUM HEAD HEIGHT					
	13'	290	12'-2" MAXIMUM HEAD HEIGHT	12'-2" MAXIMUM HEAD HEIGHT	13'	793				
12'	449	12'	105	12'	132	12'	1347			
11'	607	11'	528	11'	660	11'	1585			
10'	700	10'	766	10'	924	10'	1744			
9'	845	9'	924	9'	1135	9'	1854			
8'	951	8'	1083	8'	1320	8'	1981			
HEAD HEIGHT	6'-4" MAXIMUM HEAD HEIGHT		7'	1056	7'	1268	7'	1479	7'	2140
	6'	92	6'	1162	6'	1373	6'	1664	6'	2251
5'	280	5'	1215	5'	1479	5'	1796	5'	2409	
4'	422	4'	1320	4'	1585	4'	1954	4'	2504	
3'	565	3'	1386	3'	1690	3'	2060	3'	2631	
2'	686	2'	1479	2'	1796	2'	2193	2'	2747	
1'	803	1'	1532	1'	1876	1'	2298	1'	2800	
GPH (U.S.)	900	1500	2000	2400	2900					
WATERFALL & FILTER PUMP	PT342	PT344	PT346	PT348	PT350					
MAX-FLO	900	1500 ELECTRONIC	2000 ELECTRONIC	2400 ELECTRONIC	2900 ELECTRONIC					

POWER FLO

UNDERWATER FILTERS

Any pond is subject to conditions that affect water quality and clarity. Cloudy water can occur when a new pond is installed. Factors like rotting leaves, disturbed detritus, organic sludge and algae can combine to inhibit ideal conditions. The introduction of pond plants help maintain an ecological balance. To be absolutely sure that optimal water quality is achieved, install an adequate water filtration system. Remember, you can never have too much filtration.

SUBMERSIBLE FILTERS

1. Protect the pump from damage or clogging.
2. Filter pond water mechanically, biologically, chemically.

MECHANICAL FILTRATION

- Water is forced through a foam layer where detritus and debris are trapped, protecting the pump from damage. Also prevents clogging of subsequent filter stages, maximizing biological and chemical filtration.

BIOLOGICAL FILTRATION

- Beneficial bacteria colonize filter media, converting harmful toxins such as ammonia and nitrite into less harmful nitrate, which is consumed by pond plants. To achieve efficient biological filtration quickly, use Bio Booster.

CHEMICAL FILTRATION

- Chemical filter media, such as PhosX and Peat Granules, are effective at addressing specific concerns, like water clarity, as well as toxic components, such as ammonia and the removal and control of phosphate. All Laguna filter systems are designed to accept chemical filter media.



POWER FLO

MECHANICAL UNDERWATER FILTER



PowerFlo Filter (PT500)

Includes: 2-chambered underwater filter, 2 filter foam pads, and 1 universal Click-fit coupling.

Mechanical Underwater Filter

for ponds up to 500 U.S. gallons

Laguna PowerFlo Underwater Filters provide effective mechanical filtration – filtering out dirt and floating debris – to protect the pump from clogging, keeping pond water clean and clear. Connect to any pump with Laguna's Click-fit couplings (3/4", 1" or 1 1/4" inlet tubing). The filter can be placed near the pond's edge for easy access and maintenance.

POWERFLOMAX

BIOLOGICAL UNDERWATER FILTER



PowerFlo Max Filter (PT505)

Includes: 3-chambered underwater filter, 2 filter foam pads, Bio-Max Filter Media and 1 universal Click-fit coupling.

Biological Underwater Filter

for ponds up to 800 U.S. gallons

Laguna PowerFlo Max performs the same powerful mechanical filtration as the PowerFlo, plus it comes with an additional biological chamber with Biomax filter material to break down harmful toxins. Includes a Universal Click-fit coupling for 3/4", 1" or 1 1/4" inlet tubing.

POWER FLO

UNDERWATER FILTER ACCESSORIES



PowerFlo Mechanical

Add-On Chamber (PT509)

Expands capacity of the Powerflo Filter (PT500) or the Powerflo Max Filter (PT505).



PowerFlo Biological

Add-On Chamber (PT508)

Expands 2-chambered PowerFlo Filter (PT500) into a 3-chambered unit or, add to PowerFlo Max (PT505) for additional biological capacity.

POWER FLO

UNDERWATER MECHANICAL/BIOLOGICAL FILTER



PowerFlo Underwater

Mechanical/Biological Filter (PT1750)

for ponds up to 500 U.S. gallons

- Easily fits in round containers or small patio deck ponds
- Filter removal is easy with locking handle
- Polyester pad for efficient mechanical/biological filtration
- Carbon zeolite chemical filter pad for chemical filtration
- Complete with fittings, including universal Click-fit coupling
- Special docking area for pump installation
- 19" diameter, 4 1/2" high

POWERFLO

EXTERNAL FILTERS

These large filters are designed for large ponds and help make pond maintenance easier. They clarify water & reduce harmful toxins, thanks to large filter capacity.

POWERFLO 1000

EXTERNAL BIOLOGICAL FILTER (PT510)

For ponds 1000 - 1500 U.S. gallons



Includes: 2 removable trays, pumice filter media and foam filter, and universal Click-fit coupling for 3/4", 1" or 1 1/4" inlet tubing.

This 3-chambered filter features 2 lift-out trays for biological filtration with pumice filter material for one tray, and allows choice of media, such as BioMax (not supplied), for the second tray. A foam pad is supplied for mechanical filtration. Also includes a built-in drain plug, Click-fit coupling, and twin outlets for two waterfall or return attachments.

POWERJET

SKIMMER FILTER PUMPS

- Designed to fit all Skimmer Filters
- Completely submersible



2150
PT-431

Max. flow rate: 2142 U.S. GPH



2905
PT-436

Max. flow rate: 2905 U.S. GPH

NEW!

POWERFLO 5000

SKIMMER FILTER (PT1774)

For ponds up to 5,000 U.S. gallons (18,925 L)

- Provides complete mechanical & biological filtration for clear & healthy pond water
- Large capacity modular media chamber system
- Efficiently removes floating debris and oxygen-robbing protein film
- Self-adjusting floating door prevents fish and large debris from entering inside
- Large leaf collection basket can easily be removed and cleaned
- Heavy-duty injection molded construction
- Filters out dirt & debris, significantly reducing pump clogging and maintenance
- Performs independently or combined with Laguna Filter Falls for larger ponds up to 10,000 U.S. gallons/37,850 L

INCLUDES:

- Biospheres Biological Filter Media
- Coarse Mechanical/Biological Filter Pad



POWERFLO 5000 NEW!

FILTER FALLS (PT1770)

For ponds up to 5,000 U.S. gallons (18,925 L)

- Provides complete mechanical & biological filtration for clear & healthy pond water
- Wide spillway creates a high volume waterfall
- Large capacity modular media chamber system
- Water-oxygenating spray bar
- Four threaded bulkheads for diverting water to small waterfalls, streams or other filters
- Heavy-duty injection molded construction
- Filters out dirt & debris, significantly reducing pump clogging and maintenance
- Performs independently or combined with Laguna Skimmer Filter for larger ponds up to 10,000 U.S. gallons/37,850 L

INCLUDES:

- Mechanical pre-filtration brushes
- Coarse Mechanical/Biological Filter Pad
- Biospheres Biological Filter Media



POWER FLO

FILTER MATERIAL



NEW!

PowerFlo Replacement Filter Pad (PT1755) for Laguna Round Filter (PT1750)

- Carbon zeolite chemical filter media pad

PowerFlo Replacement Filter Pad (PT1760) for Laguna Round Filter (PT1750)

- Mechanical and biological filter media pad



Bio-Max Filter Media (PT560)

12.3 oz (350 g)

- Promotes, protects & encourages beneficial bacteria in pond water
- For clean, clear ponds
- For most pond filters

Mechanical/Biological Filter Pads

- Densely-packed & intricately-woven
- Extremely effective at filtering out particulate waste
- Custom designed to fit inside Laguna Filter Falls (PT1770) & Skimmer Filter (PT1774)

NEW!

Coarse Mechanical/Biological Filter Pad (PT1775)

Medium Mechanical/Biological Filter Pad (PT1776)

Fine Water Polishing Filter Pad (PT1777)

(each sold separately)



NEW!



BIO MESH Filter Media (PT1779)

- Reusable, economical filter media
- Helps filter out debris and fine particles
- Prevents water pumps from clogging
- Can be adjusted to achieve desired filtering density
- Easy to clean and maintain
- Can be used mechanically or biologically
- For all underwater and external pond filters

NEW!



BIOSPHERES Biological Filter Media (PT1785)

- Provides large living area for beneficial bacteria
- Maintains healthy biological conditions
- Great for degassing large ponds
- Easy to clean

NEW!



FILTER WOOL Filter Media (PT1780)

- Traps fine particles
- Polishes and helps keep pond water clear
- Prevents filter from clogging
- Non-toxic material
- For underwater & external pond filters

POWER CLEAR

UV STERILIZERS/CLARIFIERS

Kills algae and other harmful bacteria, making pond water cleaner, clearer and safer for all pond inhabitants. PowerClear UV Sterilizers/Clarifiers are equipped with an 8W or 16W UV bulb, 6 foot power cord, and Click-fit connectors for quick assembly and cleaning.



PowerClear 1000 8W UV Sterilizer / Clarifier (PT520)
Flow Rate: up to 500 GPH (U.S.).
For ponds up to 1000 U.S. gallons.
Includes: 8W UV Sterilizer/Clarifier with UV bulb and 2 Click-fit connectors.

It's easy to check if the UV bulb is working. Simply loosen one of the Click-fit connectors, and if the clear fitting glows, it's on.



PowerClear 1800 16W UV Sterilizer/Clarifier (PT522)
Flow Rate: up to 700 GPH (U.S.).
For ponds up to 1800 U.S. gallons.
Includes: 16W UV Sterilizer/Clarifier with UV bulb and 2 Click-fit connectors.

Magnetic Water Clarifier (PT1710)

Improves PowerClear UV Sterilizer performance and longevity by reducing the formation of mineral salts on the UV quartz sleeve. Installs in-line, in front of the PowerClear UV Sterilizer. Includes 2 Click-Fit hose connectors.



PowerClear 8W Replacement Bulb (PT521)



PowerClear 16W Replacement Bulb (PT523)

POWERCLEAR MAX

High Performance. Low Voltage. 50% Faster than Traditional UV Designs.

- Eliminates green water (Guaranteed)
- Spiral chamber increases UV contact time and increases efficiency by 50%
- Quartz sleeve protects bulb and maintains proper bulb temperature
- Creates beneficial pond water conditions for fish and plants
- Safe low voltage design includes 12 Volt transformer
- Can be mounted horizontally or vertically with clamps provided

NEW!



POWERCLEAR MAX 1000 (PT1650)
8 watt – 19" (48 cm)

NEW!



POWERCLEAR MAX 2000 (PT1655)
25 watt – 25" (63 cm)

NEW!



POWERCLEAR MAX 5000 (PT1660)
55 watt – 43" (109 cm)

SPITTERS

WATER FEATURES

Ever popular, whimsical Laguna Spitter Pond Ornaments add the soothing sounds of splashing water to garden and pond settings.



Single Koi-Bronze color
(PT1081)
16" x 12"
(41 cm x 30 cm)



Twin Frogs-Bronze color
(PT1083)
15" x 12"
(38 cm x 30 cm)

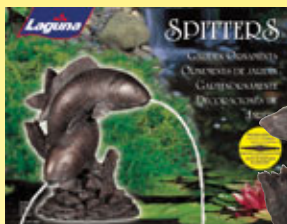

Double Koi-Bronze color
(PT1082)
16" x 13"
(41 cm x 33 cm)



Japanese Bamboo
(PT1091)
16" x 13"
(41 cm x 33 cm)

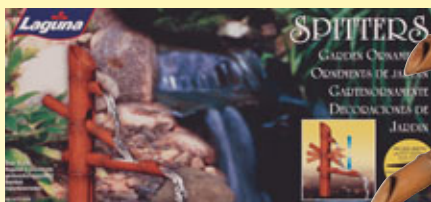

Deer Scarer
(PT1093)
16" x 12"
(41 cm x 30 cm)



ADDING SPITTERS

Laguna Spitters are pump powered and require sufficient water flow—the equivalent of 1' of head height for every 10' of hose length. Each Spitter comes complete with a Laguna Multi-Hose Adaptor to allow simple transitions to different hose sizes. Input connection 3/8" tubing included.

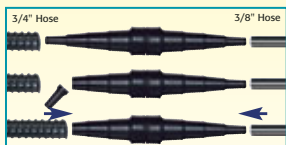



Jumping Dolphin
(PT1037)
10" x 7 1/2"
(25.5 cm x 19 cm)

Angel Boy
(PT1061)
12" x 5"
(30.5 cm x 12.5 cm)



Sitting Angel with Vase
(PT1038)
12" x 6 1/2"
(30.5 cm x 16.5 cm)



Angel with Flower
(PT1064)
11" x 5"
(27.5 cm x 12 cm)



Kneeling Angel with Vase
(PT1039)
10" x 6 1/2"
(26.5 cm x 16.5 cm)

NEW!

Angel Fish
(PT1065)
6.3" x 6.3" x 13.2"
(16 cm x 16 cm x 33.5 cm)



Goldfish
(PT1043)
7 1/2" x 8"
(19 cm x 20.5 cm)



NEW!

Blue Heron
(PT1066)
6.3" x 6.3" x 13.2"
(16 cm x 16 cm x 33.5 cm)



Bull Frog on Rock
(PT1044)
9" x 6"
(23 cm x 15 cm)

NEW!

Fire Troll
(PT1067)
5.3" x 5.3" x 12.2"
(13.5 cm x 13.5 cm x 31 cm)



Perched Frog
(PT1045)
6" x 6"
(15 cm x 15 cm)



NEW!

Golfer Boy
(PT1068)
7.1" x 5.5" x 11.8"
(18 cm x 14 cm x 30 cm)



Walking Tortoise
(PT1047)
5" x 10 1/2"
(13 cm x 26.5 cm)

NEW!

Mermaid
(PT1069)
7.1" x 5.5" x 12.6"
(24.5 cm x 18.5 cm x 32 cm)



POWER GLO

UNDERWATER POND LIGHT KIT

Add atmosphere to any night-time setting. Laguna PowerGlo incandescent pond lights operate at lower temperatures, generate less heat and are also suitable for waterfall highlighting.

PowerGlo Pond Light Kit (PT1555)

Includes: 2 submersible pond lights with bases and an 88W low voltage transformer, with 3 settings to turn lights on, off, and 4 or 6 hours after dusk. Two additional 18W Laguna lights can be added for a maximum of four lights per transformer.



PowerGlo Pond Light (PT1570)
Plastic ballast to be filled with gravel

Color Lenses
(PT1581) Red
(PT1582) Blue
(PT1583) Green
(PT1584) Amber



Replacement Bulb for PowerGlo Pond Light (PT1590)
18W bulbs

Replacement PowerGlo 88W Transformer (PT1598)

With 3 settings to turn lights on, off, and 4 or 6 hours after dusk.



WATER TEST KITS, STRIPS & TREATMENTS

Laguna Test Kits help provide all the necessary answers for perfect pond health. Easy to use. Simply test the water, evaluate the results and take the appropriate action. There are test kits for pH, hardness, ammonia and nitrite/nitrate, with up to 100 tests per individual kit. Test Strips also available.



Master Test Kit (PT170)

- Easy to use
- Immediate results
- Problem solving advice

Contains:

- pH test
- Ammonia test
- Nitrite/Nitrate test
- Hardness test



pH Test Kit (PT150)

- Correct pH is essential for health of fish and plants.
- pH is related to ammonia toxicity.



Ammonia Test Kit (PT155)

- Ammonia is toxic to fish.
- Ammonia levels are indicators of biological filtration capacity and efficiency.



Nitrite/Nitrate Test Kit (PT165)

- Nitrite is toxic to fish.
- Nitrate equals algae growth.



Hardness Test Kit (PT160)

- Correct hardness is essential for plant growth and stable pH.
- General hardness affects biological functions in fish.
- Carbonate hardness is a factor in efficient biological filtration.

Pond Test Strips (50)

- Easy to use
 - Results in seconds
- Each strip tests for:

- ✓ pH
- ✓ Total Alkalinity
- ✓ Total Hardness
- ✓ Nitrite
- ✓ Nitrate



pH Adjustup (PT175)

- Safely increases pH and KH.
- Beneficial for pond plants.

pH Adjustdown (PT177)

- Safely reduces pH.
- Phosphate free.

NEW! TRADITIONAL WATER TREATMENTS

Traditional Laguna Treatments prepare tap water for use in ponds, clear up pond water and provide growth food for aquatic plants.



Water Prep
8 oz./240 ml: (PT860)
67 oz./2 L: (PT863)

- Makes tap or well water safe for fish and plants
- Instantly eliminates chlorine and chloramine
- Coats and protects fish fins and scales



Clear Fast
8 oz./240 ml: (PT870)
67 oz./2 L: (PT873)

- Fast acting formula
- Clears cloudy or discolored water
- Safe for fish and plants
- Clumps debris for removal by mechanical filtration



Plant Grow
8 oz./240 ml: (PT865)
67 oz./2 L: (PT868)

- Chelated micro nutrient
- Promotes plant growth
- Helps keep plants strong and vigorous
- Great for floating plants
- Safe for fish
- Phosphate and nitrate free



Bio Sludge Control
8 oz./240 ml: (PT885)
67 oz./2 L: (PT888)

- Instantly activated
- Safe for fish and plants
- Breaks down organic solids and pond sludge
- Benefits the entire pond environment



Phosphate Control
8 oz./240 ml: (PT895)
67 oz./2 L: (PT898)

- Reduces phosphates naturally
- Improves water clarity
- Lasts longer than chemical treatments
- Replenishes beneficial micro-organisms



Combo Pack (PT855)
Includes four, 4 oz. (118 ml) bottles:
Phosphate Control, Clear Fast, Bio
Sludge Control and Water Prep.

NEW!



Phos-X
64 oz./1.8 kg: (PT572)

- 2 x 32 oz. packs

Reduces many compounds that encourage unsightly water conditions and foul odors by trapping phosphate, nitrite and nitrate, gradually and safely creating crystal clear water and ideal living conditions for fish and plant life.

NEW! BIOLOGICAL WATER TREATMENTS

Highly concentrated biological Laguna Treatments control phosphate, organic sludge and harmful pollutants naturally, through the introduction of beneficial bacteria to the pond. Billions of pure, safe micro-organisms per mL compete with and overwhelm problem causing bacteria, in order to re-establish correct, desirable balance in the pond water eco-system. These pure natural bacteria remain dormant until contact with oxygen.



Bio Booster
8 oz./240 ml: (PT890)
67 oz./2 L: (PT893)

- Boosts the natural biological efficiency of ponds
- Reduces and controls toxic ammonia and nitrite
- Matures filters and filter media
- Long lasting protection
- Benefits the entire pond environment
- Instantly activated

Barley Straw Pellets
2-1/2 lbs./1.13 kg: (PT575)

Convenient and effective slow release pellets help maintain clear pond water naturally. The pellets are completely natural and will support plant growth. Fish and plant friendly. One bag treats 1250 U.S. gallon (4735 L) pond.



Peat Granules for Ponds
4 lbs./1.8 kg: (PT574)

Produces a natural amber tint, which filters out sunlight, and a natural-occurring anti-fungicide that prevents fungal infections and improves coloration in fish and plants. Naturally contains acids that help lower both KH and pH levels. Recommended dosage is 4 lbs. (1.8 kg) per 1500 U.S. gallons (5600 L) for 6 weeks, placed in a filter bag (included) near running water.



Filter Bag (PT578)
For use with Peat Granules
& Barley Straw.

GOLDFISH & KOI FISH FOOD

Laguna Goldfish and Koi food pellets and sticks are available in a large variety of sizes. They come in resealable stand-up pouches to ensure that food stays fresher longer.

LAGUNA POND FISH FOOD. QUALITY NUTRITION FOR ALL FISH.

Thanks to a strong commitment to research and development, Laguna continues to make the most advanced floating fish food available. Formulated to provide superior nutrition while reducing organic waste, Laguna floating pellets and sticks include the highest quality ingredients and do not contain corn or corn starches. This complete and balanced diet contains multi-vitamins and stabilized vitamin C which improve disease resistance and help fish enjoy long, healthy lives. Laguna fish food does not cloud water and is scientifically formulated to meet the nutritional requirements of all cold water fish. It is also extremely palatable and always produces an enthusiastic feeding frenzy.



SMALL PELLETS
for fish from 4 - 8 cm

SMALL PELLETS

(PT1)	3.5 oz./100 g
(PT2)	7 oz./200 g
(PT3)	17.6 oz./500 g



MEDIUM PELLETS
for fish from 6 - 17 cm

MEDIUM PELLETS

(PT11)	3.5 oz./100 g
(PT12)	7 oz./200 g
(PT13)	17.6 oz./500 g
(PT14)	2.2 lb./1 kg



LARGE PELLETS
for fish from 15 cm & up

LARGE PELLETS

(PT23)	17.6 oz./500 g
(PT24)	2.2 lb./1 kg
(PT25)	4.4 lb./2 kg



LAGUNA STICKS
for ponds with assorted fish sizes

LAGUNA STICKS

(PT102)	7 oz./200 g
(PT103)	17.6 oz./500 g
(PT104)	2.2 lb./1 kg
(PT105)	4.4 lb./2 kg



Premium

KOI & GOLDFISH FLOATING FOOD STICKS

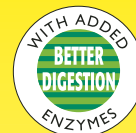

Koi & Goldfish Food Sticks

8.5 oz./240 g: (PT112)

17 oz./480 g: (PT113)

- For all seasons, and water temperature above 50°F (10°C)
- High quality basic diet
- Superior quality protein sources
- Stabilized multi-vitamin pre-mix
- Highly palatable & digestible



Koi & Goldfish Spirulina & Wheat Germ Food Sticks

10.5 oz./300 g: (PT117)

21 oz./600 g: (PT118)

- For spring & fall, when water temperature is above 42°F (6°C)
- High grade spirulina and wheat germ
- Superior protein growth formula
- Promotes brilliant colors
- Increases resistance to disease
- Stabilized multi-vitamin pre-mix
- Highly palatable & digestible



Koi & Goldfish Color Enhancing Food Sticks

11 oz./ 310 g: (PT122)

22 oz./ 620 g: (PT123)

- For all seasons, and water temperature above 50°F (10°C)
- Highly nutritious sticks, rich in krill and shrimp
- Natural color enhancing formula
- Promotes growth
- Stabilized multi-vitamin pre-mix bolsters immune system
- Highly palatable & digestible

POND NETS & SKIMMERS

- Unique design allows easy access to round pond corners
- Soft netting reduces possible harm to fish
- Net guard reduces wear when sliding net along pond edges



- (PT811) 12" Pond Net13" Handle
- (PT815) 14" Pond Net33"-60" Telescopic Handle
- (PT816) 11" Pond Net33"-60" Telescopic Handle
- (PT817) 18" Pond Skimmer .18"-30" Telescopic & Collapsible Handle
- (PT818) 18" Pond Net18"-30" Telescopic & Collapsible Handle

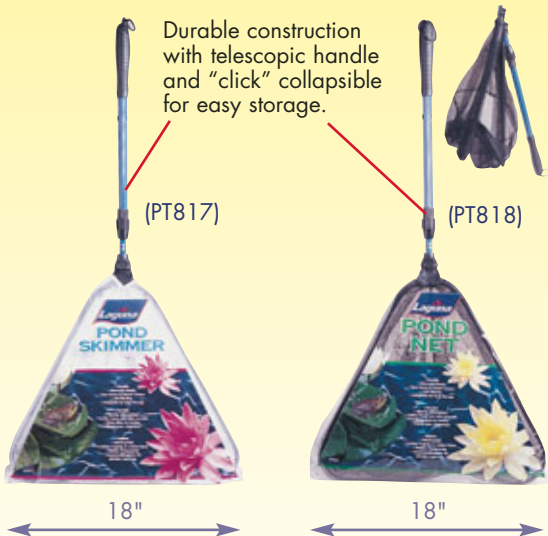

(PT813) 8"x 6" Mini Pond Net
14"-24" Telescopic Handle



(PT814) 8"x 6" Mini Pond Skimmer
14"-24" Telescopic Handle

POND NETTING



Pond Netting
(PT950) 15' x 12'
(PT951) 15' x 20'
(PT952) 20' x 30'

- Protects pond fish from predators
- Keeps leaves and other debris out of ponds
- Protects pond fish from jumping out
- Available in 3 sizes
- Stakes included to secure netting in place



FLOATING THERMOMETER

- (PT945)
- Easy-view window with large scale for quick temperature readings
 - Pond temperature is an important factor in fish health, algae build-up and overall pond health.
 - Temperature range 30-120°F, 0-50°C

LIVE PLANT ACCESSORIES

16-9-12 ONCE A YEAR FERTILIZER POND SPIKES



- For all potted aquatic plants
- Maximizes the size and color of aquatic plants
- Well-balanced feeding formula
- Low phosphorous, no adverse impact on water quality
- Contains no copper
- Non-toxic to fish and other aquatic life
- Temperature activated at 50°F (10°C)
- Lasts one full year

(PT910)

PLASTIC PLANTING BASKETS

- Baskets float and protect floating plant roots from Koi
- Includes handles for easy placement



(PT960)
Round –
8" diameter



(PT961)
Round –
10" diameter



(PT965)
Square – 9"



(PT966)
Square – 12"

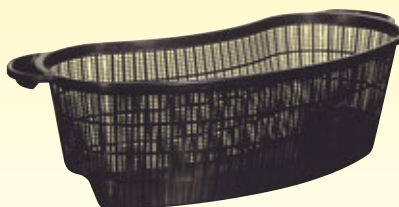

(PT968)
Contour –
18" long x 7" wide



Pruning Tool (PT819)

Helps keep ponds neat and well manicured without getting hands wet.

- The SCISSOR HEAD cuts and removes leaves from pond plants in one easy step
- The PINCER HEAD allows grasping and removal of debris with ease and precision

DECORATIONS

Always-in-Bloom Accents

Beautiful, durable and lifelike, Laguna Silk Water Lilies with plastic floats are natural accents for all Water Gardens. Colorfast and water resistant, blooming lilies and leaf pads float and move serenely in everchanging, colorful patterns.



Unique Laguna water lily plastic floats are not susceptible to natural degradation or destruction by fish.

Available in 4", 5.5", & 7" sizes and in a variety of colors



WINTERIZING A POND

Three ways to handle pond winterizing.

The Pond De-Icer allows year round water circulation.

The Pond Heater is for extreme winter conditions.

The Aeration Kit enhances oxygen/gas exchange.

NEW!

Pond De-Icer/Aerator (PT1645)

- Floating device attaches to Laguna pump outlet allowing for winter water circulation and oxygenation
- Keeps ponds open during winter to allow oxygen/gas exchange for fish safety



NEW!

Pond Heater (PT1640)

- Keeps ice from forming and helps de-gas pond, making it safe for fish
- Low power consumption – 200 watts
- Protective heat shield for fish and liner
- LED light indicates power on
- With 24' cord



NEW!

Aeration Kit (PT1630)

Enhances pond water quality all year round!

- Prevents pond surfaces from completely freezing over in winter
- Allows proper oxygen/gas exchange for fish to survive
- Enhances oxygen levels in water gardens and ponds
- Beneficial for any pond size

Kit includes:

- Powerful Aeration Pump
- 30 ft (9 m) winter safe airline tubing
- Air diffuser
- High-density styrofoam float for adjusting airstone depth

Aeration Kit Accessories:

- PT1632 Air Stone, 1"
- PT1633 Air Stone, 12"
- PT1634 Airline Tubing
- PT1635 Check Valve



WATER FEATURE KITS

Laguna Pond Kits include everything you need to create beautiful rock ponds. All kits are easy to install and can be set up to produce attractive water displays almost anywhere around the house - in backyards, sun decks or front porches. Can be installed in-ground or above-ground.



NEW!

Spitter Pond Kit (PT246)

Includes:

- PowerJet 80 GPH (U.S.) pump.
- 18 U.S. gallon (68 L) Laguna Water Reservoir (26" diameter x 12" deep).
- 10" Laguna Kneeling Angel Spitter.
- Wire grill (rocks not included)



NEW!

Japanese Garden Pond Kit (PT247)

Includes:

- PowerJet 80 GPH (U.S.) pump.
- 18 U.S. gallon (68 L) Laguna Water Reservoir (26" diameter x 12" deep).
- 16" x 12" (41 cm x 30 cm) Laguna Deer Scarer Ornament.
- Wire grill (rocks not included)



NEW!

Simcoe Pond Kit (PT241)

Includes:

- PowerJet 200 Fountain Pump Kit – 200 GPH (U.S.) pump.
- Simcoe pre-formed pond 39" x 28" x 15" (99 cm x 71 cm x 38 cm).
- 32 U.S. gallon (122 L) capacity.
- "How to Build a Pond" Instructional Video.

DURASHIELD™



PRE-FORMED PONDS

High molecular weight Polyethylene Ponds, UV stabilized.



Spillway (PT789)
50 U.S. gallons (189 L)

Champlain (PT791)
72 U.S. gallons (272 L)



Water Reservoir (PT786)
18 U.S. gallons (68 L)

Tahoe (PT792)
150 U.S. gallons (568 L)

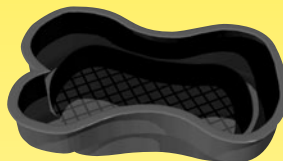

Huron (PT794)
264 U.S. gallons (1000 L)

Cascade Waterfall (PT785)



Simcoe (PT790)
32 U.S. gallons (122 L)

Hudson (PT793)
192 U.S. gallons (727 L)

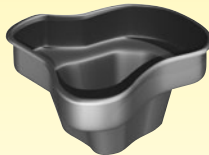

Erie (PT797)
100 U.S. gallons (379 L)

Superior (PT798)
150 U.S. gallons (568 L)

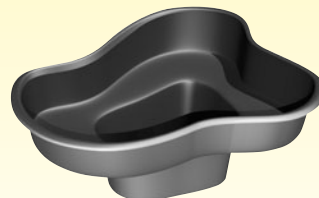

WHISKEY BARREL LINER

Laguna Whiskey Barrel Liner (PT1015)
Turns any 1/2 whiskey barrel into an instant indoor or outdoor pond. Long lasting black plastic construction, with unique accordion feature that contracts or expands to fit various sizes, prolongs barrel life.
26" Diameter x
15" High,
23 U.S. Gallons (87 L).



TUBING

PREMIUM QUALITY LAGUNA NON-KINK TUBING



Strong, durable and long lasting – will not collapse due to back-pressure or reasonable weight from gravel or cover material. Black color is hard to see once installed. For use in all pond systems.

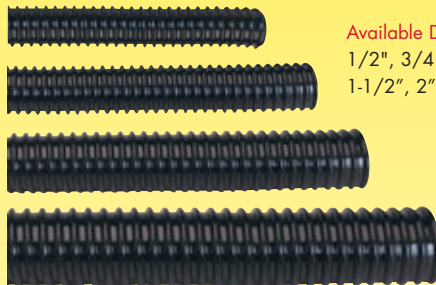

Available Diameter Sizes:
1/2", 3/4", 1", 1-1/4",
1-1/2", 2"

DURASHIELD™

POND LINERS

DuraShield™ Liners provide the durability and flexibility to create a unique and natural looking water garden. Constructed of 2-ply, 45-mil, multi-grain EPDM, these liners are guaranteed for 20 years and are safe for all pond inhabitants. Available in many sizes.

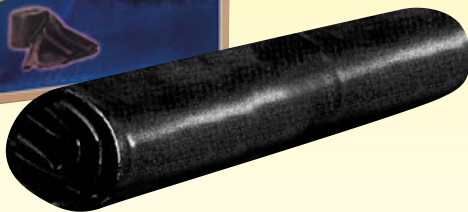

NEW!

Also available in
10' precut sizes



Silicone lubricant (PT595)
Makes tubing connections easier

YOUR QUESTIONS ANSWERED

• HOW DEEP SHOULD MY POND BE?

The minimum recommended pond depth for fish is 18", although 2 1/2 feet is considered ideal. Keep in mind that fish require cool water in the summertime and need to be able to live under the ice in the wintertime. In extremely hot or cold climates, 12" in pond depth may have considerable impact on the health of your fish.

• IS A FOUNTAIN EXPENSIVE TO OWN?

Every PowerJet pump comes complete with two fountain heads, a traditional 2 or 3-step jet and a waterbell jet, so creating beautiful fountain effects is quick and easy. A Laguna pump can cost as little to run as a 100-watt light bulb.

• CAN I PUT FISH IN MY POND?

The size and depth of your pond will determine whether or not your pond can accommodate them. When stocking a pond, it's usually a good idea to start small and add a few fish at a time. This will ensure that the biological filter system is allowed sufficient time to handle the waste generated by pond inhabitants. It is recommended to test pond water regularly to make sure that water conditions are safe for fish. For goldfish and comets, one inch of fish for every three gallons of water is a good rule of thumb. For koi, five gallons of water for every inch of fish is recommended. As the fish begin to grow, you may need to remove some of them in order to maintain an ideal pond environment. Tap water can contain chlorine, chloramine and other harmful elements that are toxic to fish. In order to make your tap water safe, it should be treated with a conditioner such as Laguna Water Prep before fish are added.

• WHAT TYPES OF PLANT ARE IDEAL FOR A GARDEN POND?

There are four major types of pond plants - oxygenating, floating, deep water and marginal. Oxygenating plants provide vital oxygen for fish and other pond inhabitants. In a mature pond, 60-70% of the pond surface should be covered with floating plants in order to reduce the development of algae. Deep water plants at the bottom of the pond provide fish with shade and protection from predators. Marginal plants along the outer edge of the pond will blend with the surrounding landscape, making it more attractive.

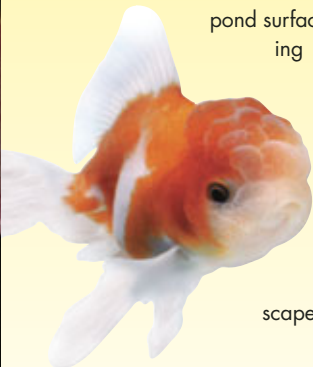

• WHY IS OXYGEN SO IMPORTANT IN MY POND?

Fish, plants and other pond inhabitants require large quantities of oxygen in order to survive. In an isolated pond, dirt, leaves, algae and other contaminants can quickly accumulate, depleting a pond's vital oxygen supply. Laguna fountains and waterfalls help to aerate oxygen-deficient ponds and help keep pond inhabitants healthy.

• WILL I GET CLEAR POND WATER RIGHT AWAY, AND HOW CAN I PREVENT IT FROM BECOMING CLOUDY OR GREEN WITH ALGAE?

With a new pond installation, the water may become cloudy until things have a chance to settle. Algae can also result from several factors, including strong sunlight, warm water and the overstocking and overfeeding of pond fish. Laguna UV Sterilizers, when used with a PowerFlo Filter, will kill and eliminate suspended algae and control harmful bacteria for cleaner, clearer pond water. Laguna PhosX and ClearFast, combined with the introduction of aquatic plants, will also improve water quality.

• ARE THERE POINTS I SHOULD CONSIDER IF I HAVE CHILDREN?

A water garden can be a fascinating, natural learning environment for children. However, before installing a garden pond, it is important to consider the layout and depth of your pond, the type of water features you plan to use and other factors that may affect its accessibility to children. One option is a "bubble" fountain where the water is pumped up from an underground tank covered with pebbles on the surface. The foaming jet creates a very attractive display as the water trickles through the stones back into the tank.

• WHAT SORT OF MAINTENANCE IS REQUIRED FOR A LAGUNA PUMP OR FILTER?

Laguna PowerJet and Max-Flo pumps require very little maintenance after installation. The cage should be checked periodically to be sure it is clear of debris in order to keep the pump running at peak performance. Laguna PowerFlo filters should be cleaned regularly (usually once every 2-3 weeks) so that they can continue to provide you with the clearest pond water possible.



HOW TO BUILD A POND

TIPS BEFORE YOU START:

Choose a level site in a sunny, open location, preferably where it can be easily viewed from the house or patio. Keep pond away from over-hanging trees and falling leaves. The fallen leaves will rot in the pond and tree roots may puncture the pond liner. Check with utility companies to make sure it is safe to dig in your site location. Choose a place near water and electrical G.F.I. outlets. Make sure the depth is adequate if you intend on over-wintering fish.

- Flexible liners can be easily shaped and sized to fit your needs and provide a natural look. Buy the heaviest liner available. We recommend Laguna Durashield liners made of fish and plant friendly, 45-mil, 2-ply, multi-grain EPDM rubber, guaranteed for 20 years.

BUILDING A POND WITH A FLEXIBLE LINER

A common mistake is to make a pond too small. If you want clear water and cool water temperatures, the pond should be at least 6 ft. x 4 ft. x 24 in. deep (1.8 m x 1.2 m x 60 cm). This is the minimum size to consider if you plan to keep fish and plants.

HOW TO CALCULATE THE REQUIRED LINER SIZE

- 1) Determine the maximum length, width and depth of your pond.
- 2) Double the depth and add it to both the length and width values.
- 3) Add an additional 2 ft. (60 cm) to both the width and length determined above to account for shelves and overlap at the pond edge.

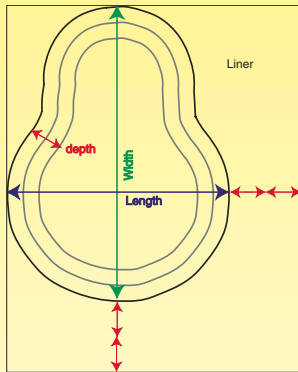

Example: If you want a pond that's 6 ft. X 8 ft. X 2 ft. deep (2 m x 2.5 m x 60 cm), you'll need a liner that's 12 ft. x 14 ft. (about 3.7 m x 4.3 m).

HOW TO CALCULATE THE NUMBER OF GALLONS OF WATER IN A POND

RECTANGULAR & SQUARE PONDS:

Length x Width x Average Depth x 7.5 = TOTAL GALLONS

ROUND PONDS:

$0.785 \times (\text{Top} \times \text{Bottom Diameter} \times \text{Depth}) \times 7.5 = \text{TOTAL GALLONS}$.

IDEAL FLOW RATE FOR POND: Pond water should circulate every 2 hours. Minimum pump flow rate capacity required is the total gallons of water in pond, divided by 2 = GPH flow rate.



1. Outline the shape of the pond using pegs and string or a garden hose. Dig out the hole using the outline as a guide. Dig down 9 inches (23 cm) at a gently sloping angle. If you plan to grow plants along the edges, cut out a 9 inch (23 cm) wide shelf. Continue digging until you reach the desired depth.

TIP: Design your pond with large open curves and flowing lines. Avoid narrow channels that can block water flow.

TIP: Slope the sides inward at a 20° angle to prevent cave-ins. In the winter, a slope allows ice to expand upwards without causing damage.

This calculation gives you enough material to line the sides, shelves and to overlap the edges.

$(\text{Depth} \times 2) + \text{Width} + 2 = \text{Liner Width}$
 $(\text{Depth} \times 2) + \text{Length} + 2 = \text{Liner Length}$



3. Fill the pond with water slowly. The liner will stretch and adapt to the shape of the pond under the weight of the water. Adjust the stones and tug the edges of the liner to form neat folds as it starts to crease. Creases will hardly be visible once the pond is full.

TIP: Mix the excavated soil with topsoil to create a rock garden or the base of a waterfall feature.

TIP: Be careful not to let the liner twist or stretch too much when filling the pond. Too much stress can cause the liner to rip or puncture.



2. Use a two-by-four and a level to make sure that the hole is level. Check that there are no stones or roots to puncture the liner. Spread a 1 inch (2.5 cm) layer of damp sand in the hole. Cover with a layer of old carpet or matting. Place the liner evenly across the hole. Let the center of the liner touch the base and shelf edges. Anchor the overlap with concrete blocks or stones.

TIP: Make sure that the rim of the pool is level across both the length and width, otherwise the pond will turn out lopsided and unattractive.

TIP: Spreading the liner out in the sunshine makes the material more flexible and easier to handle. Do not do this over the lawn, it may damage the grass.



4. When the pond is full, trim off any excess liner, leaving an overlap of at least 6 inches (15 cm). Cover the overlap with rocks, turf or paving stones.

TIP: If you place slabs or stones along the edge of the pond, let them overhang the edge slightly to hide the liner.

PARTS & ACCESSORIES

FOUNTAIN JETS

- PT650 2 / 3 STEP JET (SMALL)
- PT652 3 STEP JET (MEDIUM)
- PT654 3 STEP JET (LARGE)
- PT660 WATERBELL JET (SMALL)
- PT662 WATERBELL JET (MEDIUM)
- PT664 WATERBELL JET (LARGE)
- PT670 FOAM JET (MEDIUM)
- PT672 FOAM JET (LARGE)



HOSE FITTINGS

- PT640 UNIVERSAL FAST COUPLING 3/4"-1 1/4"
- PT641 COUPLINGS
- PT642 BALL VALVE
- PT643 Y-CLICK FIT
- PT674 MULTI-HOSE ADAPTER WITH COUPLING 1/4"-1"
- PT676 MULTI-HOSE ADAPTER (SMALL)
- PT677 MULTI-HOSE ADAPTER (LARGE)
- PT680 1/2" HOSE TEE
- PT681 3/4" HOSE TEE
- PT682 1" HOSE TEE
- PT685 1/2" HOSE BEND
- PT686 3/4" HOSE BEND
- PT687 1" HOSE BEND
- PT690 1/2" HOSE MENDER
- PT691 3/4" HOSE MENDER
- PT692 1" HOSE MENDER
- PT695 1/2" HOSE CONNECTOR
- PT696 3/4" HOSE CONNECTOR
- PT697 1" HOSE CONNECTOR
- PT700 1/2" HOSE TAP
- PT701 3/4" HOSE TAP
- PT702 1" HOSE TAP
- PT705 1/2" HOSE CLIPS (X2)
- PT706 3/4" HOSE CLIPS (X2)
- PT707 1" HOSE CLIPS (X2)
- PT1842 FLOAT VALVE



NEW!

NEW!



Distributed by:
 Canada: **Rolf C. Hagen Inc.**, Montreal, QC H4R 1E8
 U.S.A.: **Rolf C. Hagen (U.S.A.) Corp.**, Mansfield, MA, 02048
 U.K.: **Rolf C. Hagen (U.K.) Ltd.**, Castleford, W. Yorkshire WF10 5QH
 France: **Hagen France SA.**, F-77388 Combs la Ville.
 Germany: **HAGEN Deutschland GmbH & Co. KG.** 25488 Holm
 Spain: **Rolf C. Hagen España S.A.**, Av. de Beniparrell n. 11 y 13, 46460 Silla, Valencia
 Malaysia: **Rolf C. Hagen (SEA)** Sdn Bhd 43200 Cheras, Selangor D.E.
 S-2110 Printed in Canada